



**concordhomes**

# Thomasville | Two Story

TOTAL SQ. FT. | **2,983** FINISHED SQ. FT. | **2,115**  
UNFINISHED SQ. FT. | **868** BEDS | **4** BATHS | **2.5**



MAIN FLOOR

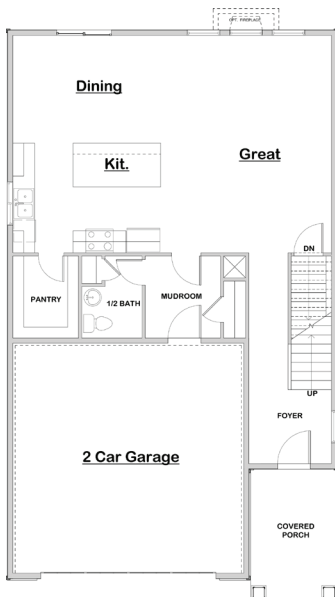

UPPER FLOOR



BASEMENT

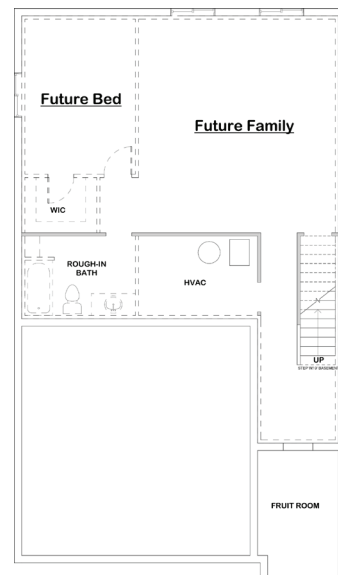

Rev 2/1/18

**801.997.0837 • CONCORDHOMESUTAH.COM**

©Concord Homes. The use of these plans, drawings and renderings is expressly limited to Concord Homes. House design, floor plan, and exterior finish may not depict standard plan. All sizes shown are estimates only. Changes may occur without notice.



# Thomasville | Two Story

TOTAL SQ. FT. | **2,983** FINISHED SQ. FT. | **2,115**  
UNFINISHED SQ. FT. | **868** BEDS | **4** BATHS | **2.5**

## HOME FEATURES

- Entertainment Kitchen
- Lots of Counter Space
- 9' Ceilings on Main Floor
- Covered Porch
- Large Mud Room
- Dual Vanity in Master Bath
- Custom, Locally-built Cabinets
- Upgraded Kitchen Cabinets; including 42" Upper Cabinets with Crown Molding
- Granite Countertops in Kitchen and Bathrooms
- Garden Tub with Separate Shower and Double Vanity in Master Bathroom
- Tile Tub/Shower Surrounds
- Custom Framed Mirrors in all Bathrooms
- Smooth Top Range
- Microwave Hood
- Wood Shelving with Organizers in Closets
- Upgraded Door Casing and Baseboards
- Wood Window Sills
- Brushed Nickel Door Hardware
- Textured or Smooth Sheetrock Interior Walls
- Two-Tone Paint
- Central Air
- 90% Efficiency Furnace
- 2 x 6 Exterior Walls Construction with R19 Insulation
- 10 Year Structural Warranty
- Front Yard Landscaping
- And Much, Much More